

---

# Technical Information Pack

---

## Venue Contacts

<b>Marie Kenny</b> <i>Programme Enquiries</i>	Programme Manager <a href="mailto:marie.kenny@sefton.gov.uk">marie.kenny@sefton.gov.uk</a>
<b>Charlotte Buckingham</b> <i>Marketing Enquiries</i>	Marketing Manager <a href="mailto:charlotte.buckingham@sefton.gov.uk">charlotte.buckingham@sefton.gov.uk</a> +44 (0) 151 934 2799
<b>Tracey Wells</b> <i>Booking Enquiries</i>	Programme Officer <a href="mailto:tracey.wells@sefton.gov.uk">tracey.wells@sefton.gov.uk</a> +44 (0) 151 934 2130
<b>Technical Office</b> <i>Technical Enquiries</i>	<a href="mailto:AtkinsonTechnical@sefton.gov.uk">AtkinsonTechnical@sefton.gov.uk</a> +44 (0) 151 934 2753

Last Updated – May 2023

# Table of Contents

Venue Contacts	2
Introduction	5
The Performance Spaces	5
Theatre	5
Studio	5
Performance Space Images	6
Theatre	6
Studio	6
Performance Space Specifications	7
Theatre - General Information	7
Theatre - Lighting	7
Theatre – Standard Lighting Rig	10
Theatre – Lighting Pre-Rig	10
Theatre - Sound	13
Theatre - Stage Management & Communications	15
Theatre - Masking Stock	15
Theatre - Projection & Cinema Systems	16
Theatre - Fly Bar Layout	17
Theatre - Ground Plan	18
Studio - General Information	19
Studio - Lighting Stock	20
Studio - Sound Stock	21
Studio - Stage Management & Communications	23
Studio - Masking Stock	23
	24

Floating Stock	25
Other Production Requirements	27
Public Liability Insurance	27
Children's Performance Licensing	27
Animal Performance License	27
Risk Assessments & CDM Regulations 2015	27
Smoking On Stage	29
Theatrical Smoke, Haze & Pyrotechnic Effects	29
Rosin & Tap Shoes	28
Scenery & Set	29
Backstage Accommodation	30
Dressing Rooms	30
Accessibility	30
Green Room	30
Laundry Facilities	30
Additional Charges	31
How To Find Us	32
By Road	32
By Train	32
Local Hire Companies	33

## Introduction

The Atkinson is Sefton Council's flagship arts and cultural venue. As a key transformational project to enhancing Southport's offer of 'England's Classic Resort', the £17 million development involves the integration of four Arts & Cultural managed venues, Southport Arts Centre, the Atkinson Art Gallery, Botanic Gardens Museum, and the Southport Library, into one regional cultural centre.

Set in a Grade II listed building in the centre of Lord Street, The Atkinson acts as a focal point for the town centre and will add to the food and beverage offer and the Lord Street retail offer to make a complete cultural visitor experience for the town.

The Atkinson delivers high quality arts and cultural entertainment from dance and drama to fine art and music, whilst supporting community art groups with their development and performances.

## The Performance Spaces

### Theatre

The stage is a traditional proscenium arch design. Full stage depth is 10m. The stage wall to wall measurement is 13m. The proscenium arch height is 7m with an overall opening width of 10m. The stage is 610mm (about 2 ft) above the auditorium floor level.

### Studio

This is an open stage venue, although with provision for a soft proscenium as and when required. Full stage depth is 5m. The stage wall to wall measurement is 14.6m. The soft proscenium arch height is 5m with an overall opening width of around 9m. The stage is 650mm (about 2.13 ft) above the auditorium floor level.

## Performance Space Images

*Theatre*



*Studio*





## Performance Space Specifications

Performance Space Specifications are subject to change, so contact the venue before your visit to confirm current specs.

### Theatre - General Information

The Theatre stage is covered with Oil Tempered Hardboard. All set must be free-standing and where necessary weighted with stage weights (we have a limited number in stock). Floor cloths and cables must be taped with LeMark Matt ProGaff (black)

The grid is split height due to the architecture of the building

Lower Grid Height (Bars 1 & 2) - 8.2m

Upper Grid Height (Bars 3 and above) - 9.4m

Bars 2, 4, 7, 10, 14, 17, 20 & 24 are flown on a powered winch system. These are reserved for Lighting & Masking Purposes (UDL 500Kgs).

All other bars are 4-Line Hemp and are available for additional masking & set requirements (UDL 100 Kgs). Please note that due to the low grid height and the height of the proscenium opening, live flying during a performance is not possible.

The Grid is of cable-net construction so has limited dead-hanging points. If you intend to dead hang set, please get in contact with us to discuss your requirements prior to arrival.

Get in is via lift through the Scene Dock located on the Ground Floor of the building.

Access to the scene dock is via the Lord Street entrance. Lift Dimensions

Length - 2.8m

Width - 1.8m

Height - 5.3m

Get In Door Height - 3m

Get In Door Width - 1.1m

Please note that no one can ride in the lift at any time, all equipment must stand of its own free will and must not need support.

FOH Lighting is positioned across 2 bridges (2 rows of 3) in the theatre roof space. All fixtures are fully accessible for rigging and focusing.

We do not allow ladders in any part of the building. Access is gained via Genie GS-1932 Scissor Lift. Access routes must be maintained around the set for lighting focusing.

The back wall of the theatre stage is painted white and can be used as a cyclorama. 4 Cell Flood Battens can be rigged to act as a RGBA colour wash.

16, 32, 64 & 125a 3 Phase Power is available USL. 16a & 32a single phase power is available at various locations around the stage. <sup>[OBJ]</sup>

### Theatre - Lighting

Control & Dimming	
Qty	Fixture
1	ETC Gio@5 2048 Channel Lighting Desk with 1 x 20 Fader wing & Dual Touch Screens
5	DMX Buffer
153	ETC Sensor+ 3Kw Dimming Channels
33	ETC Sensor+ 3Kw Non-Dimming Channels
33	Local Switched 16a Hot Power

The Theatre space operates 6 DMX universes. Universe 1 is via sACN over Ethernet and DMX. Universes 2, 3, 4, 5 and 6 via 5 pin DMX. If you require more than 6 DMX universes, please contact the Technical Office to discuss your requirements.

**Universe 1.** Control of Dimmers, House Lights, and Independents. This universe can be accessed via sACN over ethernet or via DMX. If you are bringing your own lighting console, please ensure that it is capable of transmitting sACN over Ethernet.

The IP address for touring consoles is in the range:

Address Range: 10.101.50.100 – 10.101.50.254

Subnet Mask: 255.255.0.0

Default Gateway: 10.101.255.254

**Universe 2.** This universe is for intelligent lighting on the LX bars and is fed from a DMX buffer located on the fly floor. Access to this Universe is via 5 pin DMX located at the FOH Control position.

**Universe 3.** This universe is for intelligent lighting on the LX bars and is fed from a DMX buffer located on the fly floor. Access to this Universe is via 5 pin DMX located at the FOH Control position.

**Universe 4.** This universe is for intelligent floor packages and is fed from DMX buffers located in the dimmer rack room. Access to this Universe is via 5 pin DMX located at the FOH control position.

**Universe 5.** This universe is spare. Access to this Universe is via 5 pin DMX located at the FOH Control position.

**Universe 6.** This universe is for intelligent lighting in the auditorium and is fed from a DMX buffer located in the dimmer room. Access to this Universe is via 5 pin DMX located at the FOH Control position.



Lighting Fixtures		
Qty	Fixture	Wattage
20	ETC Source 4 15-32 Degree Zoom Profile	750w
16	ETC Source 4 25 - 50 Degree Zoom Profile	750w
4	ETC Source 4 26 Degree Fixed Angle Profile	750w
38	ETC Source 4 Par (With Changeable Lens Kit by Request)	750w
38	Selecon Rama Fresnel	1200w
23	Selecon Rama PC	1200w
6	Selecon Arena Fresnel	2000w
2	Robert Juliat Topaze Compact Follow Spot	1200w MSD
16	Elumen8 Kudos 350ZS LED Moving Wash	350w LED
18	Elumen8 Virtuoso 2000 LED Fresnel	1.2 Kw (equivalent)
19	ETC Source4WRD Colour II (15-32 Degree Zoom Profile*)	500w (equivalent)
2	ADJ 18P Hex LED Par	
10	LEDJ Pixelstorm 6 TRI Batten	
6	Strand CODA 4 Cell	500w
4	Stairville PS1500 Strobe	1500w
4	Showtec Sunstrip	
8	LEDJ Slimline 7Q5 **	

*All fixtures come with colour frames, standard hook clamps and safety bonds. Floor stands & booms are available upon request.*

*\*\*Shared with Studio*

Miscellaneous	
Qty	Fixture
6	Iris for ETC Source 4 Zoom (Shared with Studio)
12	Gobo Holder for ETC Source 4 Zoom - B Size (Shared with Studio)

*We stock various Lee & Rosco gel. Please contact us in advance of your arrival to confirm colour call requirements. Various generic "B" size gobos are also in stock.*

### Theatre – Standard Lighting Rig

The Theatre maintains a standard 'house' lighting rig suitable for most music and dance performances LED front light from FOH Bay 2. Warm and cold front and side wash LX1 Backed up with LED Side Wash at barrel ends. Warm and cold back and side wash LX3 Backed up with LED Side Wash at barrel ends. Overhead LED coverage from LX bars 2, 4, 5 and 7, 4 Bars of 4 LED Moving head washes located on LX bars 2, 4, 5 and 7 and a 4-cell cyclorama wash on LX8. In addition, breakup profiles (paired doubles) are situated on LX 4 and LX 7. Specials can be picked up from FOH Bay 3, FOH Perches and LX 1 The following table lists the fixture types, modes and addressing in the 'house' rig.

### Theatre – Lighting Pre-Rig

Lighting pre-rigs are charged at £50 per hour + VAT (subject to contract and availability). Please see the Section "Additional Charges" for more information.

Channel	Universe/Address	Filter	Mode	Location	Type
1	6/1		6ch	FOH Bay 2	Source 4 15-30 Zoom Profile – Source4WRD Color II
2	6/13		6ch	FOH Bay 2	Source 4 15-30 Zoom Profile – Source4WRD Color II
3	6/25		6ch	FOH Bay 2	Source 4 15-30 Zoom Profile – Source4WRD Color II
4	1/67			LX 1	Selecon Rama Fresnel (1.2Kw) – Top Light
5	1/59			LX 1	Selecon Rama Fresnel (1.2Kw) – Top Light
6	1/63			LX 1	Selecon Rama Fresnel (1.2Kw) – Top Light
7	1/16			LX 3	Selecon Rama Fresnel (1.2Kw) – Top Light
8	1/10			LX 3	Selecon Rama Fresnel (1.2Kw) – Top Light
9	1/7			LX 3	Selecon Rama Fresnel (1.2Kw) – Top Light
11	6/7		6ch	FOH Bay 2	Source 4 15-30 Zoom Profile – Source4WRD Color II
12	6/19		6ch	FOH Bay 2	Source 4 15-30 Zoom Profile – Source4WRD Color II
13	6/31		6ch	FOH Bay 2	Source 4 15-30 Zoom Profile – Source4WRD Color II
14	1/68	L201		LX 1	Selecon Rama Fresnel (1.2Kw) – Top Light
15	1/60	L201		LX 1	Selecon Rama Fresnel (1.2Kw) – Top Light
16	1/64	L201		LX 1	Selecon Rama Fresnel (1.2Kw) – Top Light
17	1/83	L201		LX 3	Selecon Rama Fresnel (1.2Kw) – Top Light
18	1/85	L201		LX 3	Selecon Rama Fresnel (1.2Kw) – Top Light
19	1/87	L201		LX 3	Selecon Rama Fresnel (1.2Kw) – Top Light
21	1/65			LX 1	Selecon Rama Fresnel (1.2Kw) – Side Light
22	1/72			LX 1	Selecon Rama Fresnel (1.2Kw) – Side Light
23	1/90			LX 3	Selecon Rama Fresnel (1.2Kw) – Side Light
24	1/89			LX 3	Selecon Rama Fresnel (1.2Kw) – Side Light
25	1/103			LX 6	Selecon Rama Fresnel (1.2Kw) – Side Light
26	1/106			LX 6	Selecon Rama Fresnel (1.2Kw) – Side Light
31	1/66	L201		LX 1	Selecon Rama Fresnel (1.2Kw) – Side Light
32	1/71	L201		LX 1	Selecon Rama Fresnel (1.2Kw) – Side Light
33	1/91	L201		LX 3	Selecon Rama Fresnel (1.2Kw) – Side Light
34	1/88	L201		LX 3	Selecon Rama Fresnel (1.2Kw) – Side Light
35	1/104	L201		LX 6	Selecon Rama Fresnel (1.2Kw) – Side Light
36	1/105	L201		LX 6	Selecon Rama Fresnel (1.2Kw) – Side Light
41	2/417		Theatre	LX 1	Elumen8 Virtuoso 2000 Fresnel RGBAL – Side Light
42	2/426		Theatre	LX 1	Elumen8 Virtuoso 2000 Fresnel RGBAL – Side Light
43	2/435		Theatre	LX 3	Elumen8 Virtuoso 2000 Fresnel RGBAL – Side Light
44	2/444		Theatre	LX 3	Elumen8 Virtuoso 2000 Fresnel RGBAL – Side Light
45	2/453		Theatre	LX 6	Elumen8 Virtuoso 2000 Fresnel RGBAL – Side Light
46	2/462		Theatre	LX 6	Elumen8 Virtuoso 2000 Fresnel RGBAL – Side Light
51	3/60		Theatre	LX 2	Elumen8 Virtuoso 2000 Fresnel RGBAL – Top
52	3/69		Theatre	LX 2	Elumen8 Virtuoso 2000 Fresnel RGBAL – Top
53	3/78		Theatre	LX 2	Elumen8 Virtuoso 2000 Fresnel RGBAL – Top
54	3/114		Theatre	LX 5	Elumen8 Virtuoso 2000 Fresnel RGBAL – Top
55	3/123		Theatre	LX 5	Elumen8 Virtuoso 2000 Fresnel RGBAL – Top
56	3/132		Theatre	LX 5	Elumen8 Virtuoso 2000 Fresnel RGBAL – Top
61	3/87		Theatre	LX 4	Elumen8 Virtuoso 2000 Fresnel RGBAL - Back
62	3/96		Theatre	LX 4	Elumen8 Virtuoso 2000 Fresnel RGBAL - Back
63	3/105		Theatre	LX 4	Elumen8 Virtuoso 2000 Fresnel RGBAL - Back
64	3/141		Theatre	LX 7	Elumen8 Virtuoso 2000 Fresnel RGBAL - Back
65	3/150		Theatre	LX 7	Elumen8 Virtuoso 2000 Fresnel RGBAL - Back
66	3/159		Theatre	LX 7	Elumen8 Virtuoso 2000 Fresnel RGBAL - Back
71	1/95			LX 4	Source 4 15-30 Zoom Profile (750W) – Break Up
72	1/96			LX 4	Source 4 15-30 Zoom Profile (750W) – Break Up
73	1/97			LX 7	Source 4 15-30 Zoom Profile (750W) – Break Up
74	1/98			LX 7	Source 4 15-30 Zoom Profile (750W) – Break Up
111	1/69			LX 1	Source 4 15-30 Zoom Profile (750W) - Special
112	1/70			LX 1	Source 4 15-30 Zoom Profile (750W) - Special
113	1/61			LX 1	Source 4 15-30 Zoom Profile (750W) - Special
114	1/62			LX 1	Source 4 15-30 Zoom Profile (750W) - Special
121				LX 8	Cyclorama Wash – Cell 1
122				LX 8	Cyclorama Wash – Cell 2
123				LX 8	Cyclorama Wash – Cell 3
124				LX 8	Cyclorama Wash – Cell 4
131	6/37		6ch	FOH Bay 3	Source 4 15-30 Zoom Profile – Source4WRD Color II
132	6/43		6ch	FOH Bay 3	Source 4 15-30 Zoom Profile – Source4WRD Color II

Channel	Universe/Address	Filter	Mode	Location	Type
133	6/49		6ch	FOH Bay 3	Source 4 15-30 Zoom Profile – Source4WRD Color II
134	6/55		6ch	FOH Bay 3	Source 4 15-30 Zoom Profile – Source4WRD Color II
141	6/61		6ch	FOH Bay 3	Source 4 15-30 Zoom Profile – Source4WRD Color II
142	6/67		6ch	FOH Bay 3	Source 4 15-30 Zoom Profile – Source4WRD Color II
143	6/73		6ch	FOH Bay 3	Source 4 15-30 Zoom Profile – Source4WRD Color II
151	6/79		6ch	FOH Bay 3	Source 4 15-30 Zoom Profile – Source4WRD Color II
152	6/85		6ch	FOH Bay 3	Source 4 15-30 Zoom Profile – Source4WRD Color II
153	6/91		6ch	FOH Bay 3	Source 4 15-30 Zoom Profile – Source4WRD Color II
154	6/97		6ch	FOH Bay 3	Source 4 15-30 Zoom Profile – Source4WRD Color II
161	6/103		6ch	FOH Perch L	Source 4 15-30 Zoom Profile – Source4WRD Color II
162	6/109		6ch	FOH Perch L	Source 4 15-30 Zoom Profile – Source4WRD Color II
163	6/115		6ch	FOH Perch L	Source 4 15-30 Zoom Profile – Source4WRD Color II
164	1/58			FOH Perch L (Rear)	Source 4 15-30 Zoom Profile
171	6/121		6ch	FOH Perch R	Source 4 15-30 Zoom Profile – Source4WRD Color II
172	6/127		6ch	FOH Perch R	Source 4 15-30 Zoom Profile – Source4WRD Color II
173	6/133		6ch	FOH Perch R	Source 4 15-30 Zoom Profile – Source4WRD Color II
174	1/47			FOH Perch R (Rear)	Source 4 15-30 Zoom Profile
181	6/139		12ch	FOH Perch L	ADJ 18P Hex
182	6/151		12ch	FOH Perch R	ADJ 18P Hex
301	2/1		26ch	LX 2	Elumen8 Kudos 350ZS – Moving Head
302	2/27		26ch	LX 2	Elumen8 Kudos 350ZS – Moving Head
303	2/53		26ch	LX 2	Elumen8 Kudos 350ZS – Moving Head
304	2/79		26ch	LX 2	Elumen8 Kudos 350ZS – Moving Head
311	2/105		26ch	LX 4	Elumen8 Kudos 350ZS – Moving Head
312	2/131		26ch	LX 4	Elumen8 Kudos 350ZS – Moving Head
313	2/157		26ch	LX 4	Elumen8 Kudos 350ZS – Moving Head
314	2/183		26ch	LX 4	Elumen8 Kudos 350ZS – Moving Head
321	2/209		26ch	LX 5	Elumen8 Kudos 350ZS – Moving Head
322	2/235		26ch	LX 5	Elumen8 Kudos 350ZS – Moving Head
323	2/261		26ch	LX 5	Elumen8 Kudos 350ZS – Moving Head
324	2/287		26ch	LX 5	Elumen8 Kudos 350ZS – Moving Head
331	2/313		26ch	LX 7	Elumen8 Kudos 350ZS – Moving Head
332	2/339		26ch	LX 7	Elumen8 Kudos 350ZS – Moving Head
333	2/365		26ch	LX 7	Elumen8 Kudos 350ZS – Moving Head
334	2/391		26ch	LX 7	Elumen8 Kudos 350ZS – Moving Head
1001	1/251 thru 1/262			Auditorium	House Lights
1011	6/208			Auditorium	LEDJ Alu Tri PAR 64 – Tab Warmers - High
1012	6/215			Auditorium	LEDJ Alu Tri PAR 64 – Tab Warmers - Low
1021	6/168		5ch	Auditorium	LEDJ Pixel Storm 6 Tri Batten – House LED
1022	6/173		5ch	Auditorium	LEDJ Pixel Storm 6 Tri Batten – House LED
1023	6/178		5ch	Auditorium	LEDJ Pixel Storm 6 Tri Batten – House LED
1024	6/183		5ch	Auditorium	LEDJ Pixel Storm 6 Tri Batten – House LED
1025	6/188		5ch	Auditorium	LEDJ Pixel Storm 6 Tri Batten – House LED
1026	6/193		5ch	Auditorium	LEDJ Pixel Storm 6 Tri Batten – House LED
1027	6/198		5ch	Auditorium	LEDJ Pixel Storm 6 Tri Batten – House LED
1028	6/203		5ch	Auditorium	LEDJ Pixel Storm 6 Tri Batten – House LED
2001	1/200 thru 1/250				NON - DIM

ETC Patch files are available upon request from [AtkinsonTechnical@sefton.gov.uk](mailto:AtkinsonTechnical@sefton.gov.uk)

*Theatre - Sound*

Mixing & Playback	
Qty	Equipment
1	Yamaha CL3 64 Channel Digital Mixing Desk
1	Yamaha Rio3224-D2 32/16 Digital Stagebox (Located on theatre stage)
1	Yamaha Rio1608-D2 16/8 Digital Stagebox (Located at FOH control position)
1	Apple Mac Mini with Q-Lab5

Sound Reinforcement & DSP		
Qty	Equipment	Notes
2	EM Acoustics MSE-156	Pros L & R
2	EM Acoustics MSE-156	Delay L & R
4	EM Acoustics EMS-118	Sub L & R
4	EAW JF-50 Front Fills	Front Fill
1	Yamaha DME-24N Digital Signal Processor	

- 24 stage sends are provided between FOH control position and stage via three VDM multicore points located down stage left behind the SM Desk.
- 16 stage sends are provided between FOH control position and are presented on a stage box in the down-stage right wing.
- Six returns are provided for monitor mixes (via Rack Room) with a further six more to stage if required.
- 4 x Cat 5E cable runs are provided between FOH control position and the down stage right wing.
- Please note that due to the construction of the auditorium we are unable to accommodate company provided multicores between FOH control and stage.
- 4 flown stage foldback speakers are provided as a Stereo return covering both up and down stage areas.
- Please note, we can only provide a maximum of eight (8) monitor mixes on stage.

Radio Microphones	
Qty	Equipment
8	Sennheiser EW 100 G3 Receivers (Channel 38 License)
2	Sennheiser ASA RF distribution with Omni-directional paddles
4	Sennheiser EW100 G3 / EW135 G3 GB Handheld Radio Mics
4	Sennheiser EW100 G3 / EW112 G3 GB Lavalier Radio Mics with Tie Clips

- Companies are welcome to bring their own radio mic stock but must provide copies of licenses prior to fit up.
- Please note that we do not provide headset microphones. Companies are welcome to bring their own or we can arrange to hire headset microphones for you. Please contact the Technical Office to discuss your requirements prior to your arrival.

### Theatre - Stage Management & Communications

- 1 x GDS Custom Built Stage Management Desk is located in the DSL corner, with the following modules;
  - 2 Ring Communication Circuit (A & B) - Channel A linked into radio comms
  - 12 Channel Q-Light Master Station
  - Show Relay Speaker with Local & Global Mute Control
  - Dual Video monitors linked to Standard and IR camera System
  - Venue Clock
  - Show Timer
- Comms & Patchable Q-Light points are strategically placed around the venue. Single & Dual Channel comms headsets are available on request.
- Stage management position also encompasses Safety Curtain Control, House Tab Control, Drencher Control, Cinema Screen Control, House Light Control & Working Light Control.

### Theatre - Masking Stock

Qty	Cloth	Dimensions
2	House Tabs - Red	5500 x 7700
4	Cross Stage Curtains - ½ Tabs & Full Black	5500 x 7500
1	Straight Border - House Border	10000 x 2500
4	Straight Border	11000 x 2500
6	Legs	1500 x 6500
8	Legs - Lateral Masking	3000 x 5300
1	Cyclorama	10000 x 8000

- Lateral masking is provided SL & SR by means of 4 x Lateral Masking Legs on walk along tracks mounted under the fly and op-fly floors.
- Red House tabs on a fixed speed motorised track are rigged just upstage of the setting line.
- 1 x House Border and all legs are permanently rigged on fixed bars and cannot be repositioned.
- 2 x Cross stage curtains are permanently rigged on a hand line track downstage of winch bar 5. These act as a mid-stage full black and cannot be moved. When open they act as mid stage legs.
- 2 x Cross stage curtains are permanently rigged on a hand line track upstage of winch bar 8. This acts as a full black and cannot be moved. When open it acts as a US pair of legs.
- All other masking may be moved by prior arrangement.
- Please note, the venue does not have any hard masking.
- Please note, the minimum drop length for cloth borders is 2.5m and 6.5m for cloth legs.



### Theatre - Projection & Cinema Systems

Please note, the Cinema Projection system is only available for Cinema-based events and is not available for use in theatre productions due to the proximity of the screen to the stage edge (less than 1m).

Qty	Equipment
1	DP2K-15C Digital Cinema Projector with 3Kw Xenon Lamp and fixed focus lens.
1	Dolby DSS-220 Digital Cinema Server (With IMB in Barco Projector)
1	DataSAT AP-20 Digital Cinema Surround Sound Processor
1	Wyrestorm Scaler (patch for VGA, S-VIDEO, Composite, Component, HDMI & DVI)
1	Sony S790 Blu-ray Player

#### Video Formats & Quality

- HIGHEST QUALITY - 2K DCP (Digital Cinema Package) file loaded onto Dolby DSS-220
  - Must be DCI compliant (<http://www.dcinovies.com>)
  - Either Flat (1998 x 1080 – Aspect Ratio 1.85) or Cinemascope (2048 x 858 – Aspect Ratio 2.39)
  - JPEG 2000 Compression
  - 24 Frames Per Second
  - Up to 7.1 Cinema Surround Sound (also accept 5.1)
  - Named using naming conventions (<http://digitalcinemanamingconvention.com>)
  - Delivered on eSATA HDD (or USB – but will take longer to transfer onto Dolby DSS220)
- MEDIUM QUALITY – Blu-ray & DVD
  - Standard Blu-ray player operating over HDMI thru 1080p Video Switch
  - 5.1 Audio Maximum
- OTHER MEDIA & INPUTS
  - Laptops via VGA & HDMI through Video Switcher
  - 2.1 Audio maximum

#### 7.1 Cinema Surround Sound

Qty	Equipment
6	QSC SR-1020 Surround Loudspeaker
2	QSC SR-1030 Surround Loudspeaker
1	QSC CX-404 Power Amplifier

#### Speakers Arranged;

- 4 x SR-1020 Surround Left
- 4 x SR-1020 Surround Right
- 1 x SR-1030 Rear Left
- 1 x SR-1030 Surround Right
- When operating in 5.1 rear speakers take feed from surround channels.

Theatre - Fly Bar Layout

Bar #	Type	UDL Kgs	From Setting Line (mm)	Bar Length (mm)	Notes
1	H	100	739	10000	
2	W	500	1050	10000	LX 1
3	H	100	1490	10000	
4	H	100	3259	10000	
5	W	500	3540	10000	LX 2
6	H	100	4008	10000	
7	H	100	4290	10000	
8	W	500	4459	10000	LX 3
9	H	100	4907	10000	
10	H	100	5094	10000	
11	W	500	5320	10000	LX 4
12	H	100	5907	10000	
13		250	6915	10500	Mid Stage Tabs
14	H	100	6925	10000	
15	H	100	7086	10000	
17	W	500	7302	10000	LX 5
20	W	500	8192	10000	LX 6
21	H	100	8635	10000	
22	H	100	8804	10000	
23	W	500	9210	10000	LX7
24	H	100	9708	10000	
25	H	100	9893	10000	
26	H	100	10114	10000	
27	W	500	10285	10000	LX 8
28		250	10918	10500	Full Black

- We require at least 2 members of crew on the fly floor at any time when hemp bars are moving.
- Winch bars are operated by venue technicians with specific training. If a member of the show crew is required to operate winch bars, please contact us in advance and we can arrange training on the day of your visit.
- We do not recommend full height cloth flying DS of bar 5 due to grid height & sight lines, we also recommend bringing cloth clips.

# Theatre - Ground Plan

LOAD  
IN  
LIFT

SAFETY CURTAIN

25	H	
24	W	
23	H	
22	H	
21	H	
20	W	
19	H	
18	H	
17	W	
16	H	
15	H	
14	W	
13	H	
12	H	
11	H	
10	W	
9	H	
8	H	
7	W	
6	H	
5	H	
4	W	
3	H	
2	W	
1	H	

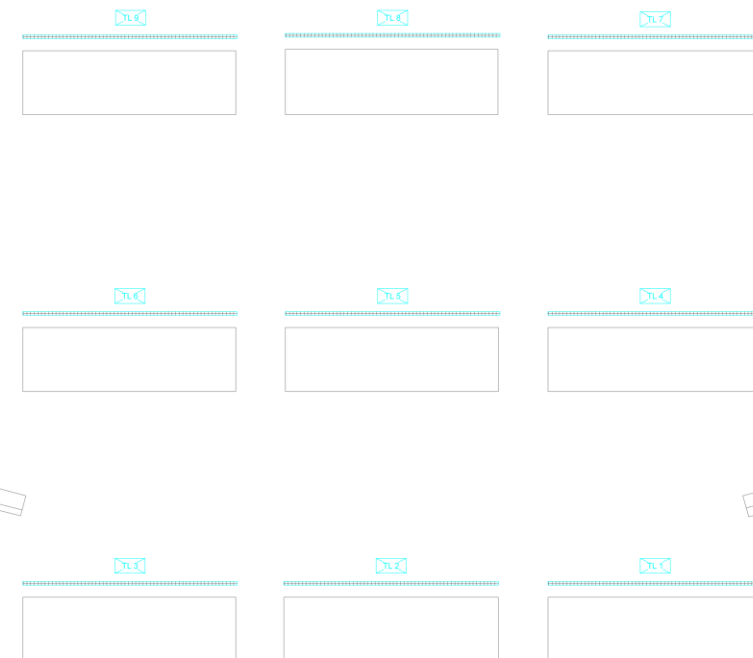

**NTS**  
**DO NOT SCALE FROM THIS DRAWING**

### Studio - General Information

The Studio Stage is covered with Oil Tempered Hardboard. All set must be free-standing and where necessary weighted with stage weights (we have a limited number in stock). Floor cloths and cables must be taped with LeMark Matt ProGaff (black)

The studio benefits from a fixed truss grid, accessed by Genie Lift. This allows for on stage lighting positions and masking.

Access to FOH lighting is via a series of catwalks and gantries, lights can be double stacked on the catwalks due to 2 sets of rails.

Get in is via lift straight from Sharrock Street at the back of the building.

Length - 2.8m

Width - 1.1m

Height - 4m

Please note there is a tight corner to maneuver once out of the lift on stage level.

The studio is permanently rigged with a black wrap around covering the entire stage space.

Seating can be arranged in several configurations;

- Bleacher Seating
- Cabaret Style
- Standing

If the bleacher is away there is no in auditorium access between the control positions FOH and the stage.

The Studio Bar is to the Auditorium Left. Prior to performances and during the interval the bar may be open at the duty manager's discretion. Once the performance has begun the bar will stop serving, however the acoustic wall will remain open.

The auditorium can be accessed via 1 set of treads which are placed extreme SR. If you do not require these please let us know in advance and they will be removed.

Left and right PA speakers are ground stacked on stage, please take this into account when planning shows.

32a Single phase is available USR & USL.

32a Three Phase (TPNE) is available on the stage right lighting gantry.

63a Three Phase (TPNE) is available on the up-stage right wall.

**Studio - Lighting Stock**

<b>Control &amp; Dimming</b>	
<b>Qty</b>	<b>Fixture</b>
1	ETC Ion Xe 2048 Channel Lighting Console with 10 x 20 Fader wing & Dual Touch Screens
2	DMX Buffer
72	Zero 88 2 Kw Chilli Dimmer Channels
24	Zero 88 3 Kw Chilli Non-Dimming Channels
12	ETC 3kw Dimmer Channels

Studio space operates 4 DMX universes. Access is via 5 pin DMX circuits located in the FOH control position.

**Universe 1.** Control of Dimmers, House Lights, and Independents.

**Universe 2.** This universe is used for House LED and intelligent lighting etc.

**Universe 3.** This universe is spare and available to production companies.

**Universe 4.** This universe is spare and available to production companies.

<b>Lighting Fixtures</b>		
<b>Qty</b>	<b>Fixture</b>	<b>Wattage</b>
9	ETC Source 4 15-32 Degree Zoom Profile	750w
6	ETC Source 4 25 - 50 Degree Zoom Profile	750w
12	ETC Source 4 Par (With Changeable Lens Kit by request)	750w
8	ADJ 18P HEX LED Wash	
4	eLumen8 Virtuoso 2000 RGBAL Fresnel	1.2 Kw (equivalent)
4	Showtec Phantom 50 LED Moving head Spot	50w LED

*All Fixtures come with colour frames, standard hook clamps and safety bonds. Floor Stands and booms are available on request.*

<b>Miscellaneous</b>	
<b>Qty</b>	<b>Fixture</b>
6	Iris for ETC Source 4 Zoom (Shared with Theatre)
12	Gobo Holder for ETC Source 4 Zoom - B Size (Shared with Theatre)

*We stock various Lee & Rosco gel. Please contact us in advance of your arrival to confirm colour call requirements.*

*Various generic “B” size gobos are also in stock.*

**Studio - Sound Stock**

Mixing & Playback	
Qty	Equipment
1	Behringer X-32 Digital Mixing Console
2	Behringer S16 16/8 Digital Stagebox
1	Behringer SD16 16/8 Digital Stagebox
1	Apple Mac Mini with QLab
1	Yamaha LS-9 Digital Mixing Console (available by request)

Sound Reinforcement & DSP		
Qty	Equipment	Notes
2	Shermann Audio	Stage L & R
2	Funktion One – Preproduction prototype Subs	Stage Mono
2	Logic Systems Ethos B300 Sub (1000w)	Stage Mono
2	EM Acoustics EMS-51	Centre Fills
2	EM Acoustics MSE-121X	Stalls Fill L & R
2	EM Acoustics EMS-156	Circle L & R
2	K&F	Rear Fills*
1	Yamaha DME-24N Digital Signal Processor	

\*NOT DSP CONTROLLED, please speak to the tech team to arrange use if required.

- 32 sends are provided digitally via S16 & SD16 Stage boxes via CAT5e cable run between stage and FOH
- Up to 24 returns are provided digitally via S16 and SD16 boxes via CAT5e cable run
- Alternatively, 24 stage sends are provided down 3 x VDM multicore points located in various points around the stage and at the FOH control position.
- There are no analogue return points on stage level
- Please note, we can only provide a maximum of eight (8) monitor mixes on stage. These come via an Amp rack on stage

- Company provided multicores must be at least 60M as the cable run is via the roof space.

Radio Mic System	
Qty	Equipment
2	Sennheiser EW 100 G3 Receivers (Channel 38 License)
1	Sennheiser ASA RF distribution with Omni-directional paddles
2	Sennheiser EW100 G3 / EW135 G3 GB Handheld Radio Mics

Companies are welcome to bring their own radio mic stock but must provide copies of licenses prior to fit up.

Please note that we do not provide headset microphones. Companies are welcome to bring their own or we can arrange to hire headset microphones for you. Please contact the Technical Office to discuss your requirements prior to your arrival.



**Studio - Stage Management & Communications**

1 x GDS Custom Built Stage Management is located in the USR corner, with the following modules;

- 2 Ring Communication Circuit (C & D) - Channel C linked into radio comms
- 12 Channel Q-Light Master Station
- Show Relay Global Mute Control
- Dual Video monitors linked to Standard and IR camera System
- Venue Clock
- Show Timer

Comms & Patchable Q-Light points are strategically placed around the venue. Single & Dual Channel comms headsets are available on request.

Stage management position also encompasses House Tab Control, Cinema Screen Control, House Light Control & Working Light Control.

**Studio - Masking Stock**

Qty	Cloth	Dimensions
2	X - Stage Curtains	7000 x 5300
2	Legs	2000 x 5300
8	Legs - Wrap Around	3000 x 5300
1	Border - Truss Front	13300 x 600

- Wrap around masking is provided SL & SR by means of 8 x Lateral Masking Legs on walk along tracks mounted under the truss
- Black tabs on a variable speed motorised track are rigged just upstage of the setting line permanently.
- 1 x House Border & 2 x Legs are permanently rigged from the truss and cannot be moved.

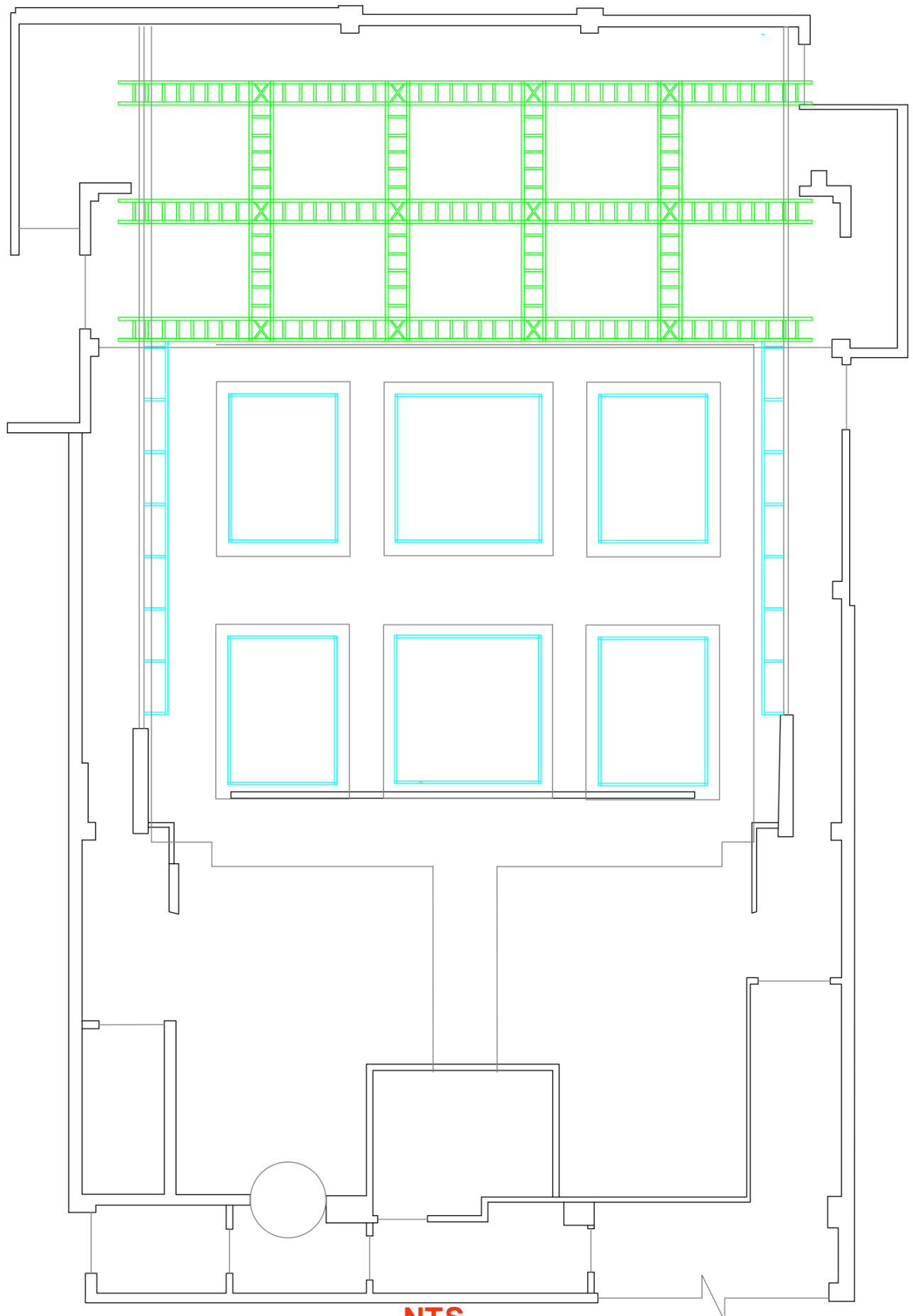

**NTS**  
**DO NOT SCALE FROM THIS DRAWING**



Cutts & Taylor Event Management  
C/O The Atkinson  
Lent Street, Rochdale  
M20 2BQ

**The Atkinson - Studio**

Studio Ground Plan  
1:75 @ A3 | 25/04/2014  
ATK/GPL/ST/1 | SJH



*Floating Stock*

Floating stock can be allocated to either venue. Please contact the Technical Office in advance to arrange stock bookings. Please note that Technical Specifications and Stage Plans for bands will be automatically allocated stock.

Microphone Stands	
Qty	Equipment
16	K&M Small Microphone Boom Stands
18	K&M Tall Microphone Boom Stands
2	K&M Tabletop Microphone Stands

Microphones & Direct Injection Boxes	
Qty	Equipment
15	Shure SM57
15	Shure SM58
10	Shure PG81
5	Shure Beta 58A
4	Shure Beta 57A
1	AKG Premium Drum mic kit
1	Shure DMK57-52 Drum mic kit
10	BSS Active DI Box
1	Shure Beta 52A
4	AKG C1000
2	Rode M3

Inputs & Cabling	
Qty	Equipment
6	VDM 8 Way Stage Box (M & F XLR)

- The Atkinson carries enough cable to run all in house stock including a limited stock of XLR.
- Please note we do not stock Jack cables so these must be provided by artists if being used for instruments.

Monitors	
Qty	Equipment
11	EM Acoustics M12
3	Martin Audio LE 400

The Atkinson has 24 sections of fixed height Sico Deck rostra on site. Available sizes are:

12" height	-	8 sections of 8ft by 3ft
18" height	-	8 sections of 8ft by 3ft
24" height	-	8 sections of 8ft by 3ft

The Atkinson also has several handrails and steps available for use. Please note that we do not stock any skirt for the stage decks.

## Other Production Requirements

### Public Liability Insurance

All productions are required to have public liability insurance which must be submitted with a copy of the public liability declaration form before production can take place.

### Photography and Filming During a Performance

The Atkinson reserves the right to ban any photography and video recording during any performance. It will be at the discretion of the duty manager and / or the venue Stage Manager to allow any photography and / or video recording of any kind, this will be discussed with the CSM / organiser prior to the performance.

For safeguarding and legal reasons in performances involving children The Atkinson withholds the right to ban any photography and video recording unless the performance is being professionally shot by a registered professional holding a current DBS (Disclosure Barring Service) certificate. The photographer must be named on any booking forms by the company and communicated to the venue prior to the performance taking place. Under no circumstances will photography or video recording be permitted by any member of the public at any time.

### Children's Performance Licensing

Under the Children (Performances) Regulations 1968 any children in performance at The Atkinson must be covered by a license or body of persons exemption for both rehearsals and performances. A copy of the License must be submitted to The Atkinson fourteen days before arrival. Any young person without a license will not be allowed access to the backstage and stage areas.

Any person who fails to observe any condition to which a license is granted or knowingly or recklessly makes any false statement in or in connection with an application for a license is liable to a fine not exceeding level 3 on the standard scale (currently £1000) or imprisonment for a term not exceeding three months or both (section 40 of the Children and Young Persons Act 1963)

### Animal Performance License

The visiting Hirer must supply a copy of the performance license for any animal taking part in their event. A copy of the agreed license must be given to The Atkinson before the event takes place. For further information visit [Animal Welfare licensing \(sefton.gov.uk\)](http://sefton.gov.uk)

### Risk Assessments & CDM Regulations 2015

Risk assessments must be produced for all activities that form part of the production (for example, raised platforms).

The Atkinson holds risk assessments and safe operating procedures for day-to-day tasks undertaken by the crew (for example lighting rigging).

Where a set is to be constructed (including rigged and struck during a performance), the incoming company is responsible for producing the appropriate Construction Phase Plans, Risk Assessments and Method Statements. Please submit your CPP and RAMS documentation to the Atkinson Technical Department at least four weeks before the performance date. For further information on Construction Design & Management Regulations (2015) and how it applies to the entertainment industry, please follow the link below.

HSE CDM Website <http://www.hse.gov.uk/entertainment/cdm-2015/introduction.htm>

### Smoking On Stage

The Atkinson permits smoking on stage; however, a full risk assessment & smoking plot must be provided upon arrival. A smoking plot should contain the following;

- Actor To Be Smoking
- Q-Page and Line for lighting cigarette
- Method of lighting cigarette
- Blocking whilst cigarette is lit
- Q-Page and Line for extinguishing cigarette
- Method of extinguishing cigarette (such as gel in ashtray)

### Theatrical Smoke, Haze & Pyrotechnic Effects

The Atkinson allows all the above, however in the case of pyrotechnics please contact us in advance to discuss your requirements.

Please note that we do not allow Open Flame, Dry Ice & or Compressed Gas effects at any time. Low Fog is permitted in the form of standard smoke fluid run through a chiller unit (e.g., Jem Glaciator)

### Rosin & Tap Shoes

The use of rosin, tap shoes or clogs is not allowed directly on The Atkinson's stage floors due to the extensive damage this causes. Any performance on stage that requires the use of rosin, tap shoes or clogs will require incoming companies to provide Marley dance floor to protect the stage. If any damage occurs from dancing on the stage, the cost to repair will be charged back to the incoming company at a minimum of £25 +VAT per hour plus the cost of materials.

### Scenery & Set

All incoming scenery and set must be treated with a flame-retardant solution compliant with the following standards: -

*BS476 parts 6 and 7, BS5867 part 2 1980, BS3119/3120, BS5852 and BS5665*

Self-built set that does not have fire safety certificates or other proof of flame-retardant treatment will be subjected to a 10 second flame thrower test by The Atkinson technicians prior to entering the building. Any set or scenery that fails the test will not be allowed to enter the building.



## Backstage Accommodation

### Dressing Rooms

The Atkinson has 10 dressing rooms available over 3 floors with the ability to hold a maximum of 97 persons at any one time. All dressing rooms are equipped with dressing tables, mirrors, mirror lights and sinks. Details of these can be found below;

Dressing Rooms			
Nr	Floor	Capacity	Notes
1	3	3	
2	3	5	
3	3	5	Reserved for Studio
4	2	8	Male Only
5	2	15	Ensemble
6	2	15	Ensemble
7	2	15	Ensemble
8	2	15	Ensemble
9	1	8	
10	1	8	Production Laundry

There are also male and female toilets on the First and Second Floors. The first-floor toilets also have shower facilities for performers.

All dressing rooms have audio show relay & BOH announcement speakers. Corridors and toilets are also equipped with BOH announcement speakers.

### Accessibility

The stage level is fully accessible to performers and crew with impaired mobility. Dressing room 3 is also fully accessible and has an accessible ensuite wet room.

Please note, access to the stage from the First & Second floor levels is via stairs only.

### Green Room

The green room is on the fourth floor and contains refreshment facilities and sofas.

### Laundry Facilities

Washing and drying facilities are available in dressing room 10. Please see technical crew on the day for access.

### Additional Charges

The Atkinson will provide a Stage Manager and Venue Electrician who will be responsible for the operation of the Lighting and Stage Management. The Atkinson will only provide additional technicians by prior agreement with the Production Company or Hirer, and these will be charged back to the Production Company or Hirer at the rates shown in the table below.

The Atkinson provides access to the in-house PA system (consisting of sound console, amplifiers, speakers, monitors, microphone stands and cabled microphones) and Lighting system (consisting of lighting console, lighting fixtures and cabling) to the Production Company or Hirer as part of the agreement. Other equipment required by the Production Company or Hirer may incur additional charges as show in the table below.

Description	Daily Rate	Weekly Rate	Notes
Additional Technician (min 4-hour call)	£25.00 + VAT per hour		Subject to contract and availability.
Follow spot Operator	£25.00 + VAT per hour		Subject to contract and availability.
Radio Microphone (Handheld)	£25.00 + VAT per microphone	£75.00 + VAT per microphone	Subject to contract and availability.
Radio Microphone (Body Pack)	£25.00 + VAT per microphone	£75.00 + VAT per microphone	Subject to contract and availability.
Jem Compact Hazer Pro	£12.00 + VAT	£60 .00 + VAT	Subject to contract and availability.
Jem ZR422 Smoke Machine	£12.00 + VAT	£60 .00 + VAT	Subject to contract and availability.
Yamaha M7 CL Monitor Desk	£100.00 + VAT	£300.00 + VAT	Subject to contract and availability.
Yamaha LS9-32 Monitor Desk	£50.00 + VAT	£150.00 + VAT	Subject to contract and availability.
Steinway Concert Grand Piano (Theatre)	£120.00 + VAT	£360.00 + VAT	Subject to contract and availability.
Steinway Baby Grand Piano (Studio)	£120.00 + VAT	£360.00 + VAT	Subject to contract and availability.
Piano Tuning	£70.00 + VAT		Subject to contract and availability.
Lighting Pre-rig/Reset	£50.00 + VAT per Hour		Subject to contract and availability.
Projector (Epson WUXGA 5k) + 12' 16:9 Projection Screen	£125.00 + VAT	£375.00 + VAT	Subject to contract and availability.

## How To Find Us

### By Road

From the South, take the M6 to exit 26; the M58 will take you to Ormskirk and then take the A570 to Southport.

From the North, follow the A59 from Preston (exit 31 from the M6) and then follow the signs to Southport.

Theatre Load in is from Lord Street, Studio Load in is from Sharrock Street (Off Eastbank Street)

### Parking

There is no parking available at The Atkinson. On-road pay, and display parking is available in the immediate vicinity of the venue as well as several off-road car parks.

For more detailed car parking information in Southport please visit [sefton.gov.uk/parking](http://sefton.gov.uk/parking)

### By Train

Northern Rail operates regular services to Southport from Manchester Airport, Manchester (Piccadilly, Oxford Road, and Victoria stations), Bolton and Wigan. Connecting services to / from the Northeast and Yorkshire are available at Manchester Piccadilly and from the North, Scotland and the South at Wigan.

Mersey Rail operate fast and frequent services between Liverpool South Parkway (for Liverpool John Lennon Airport), Liverpool City Centre and Southport.

For further rail enquiries please visit the [National Rail website](http://www.nationalrail.co.uk).

## **Local Hire Companies**

### **Crystal Sound & Light**

Unit 3, Kelvinside  
Wallasey  
Merseyside  
CH44 7JY

Tel: 0151 345 9909  
[www.crystalsoundandlight.co.uk](http://www.crystalsoundandlight.co.uk)

### **MSP Global**

MSP House, Bridle Way  
Bootle  
Merseyside  
L30 4UA

Tel: 0344 811 0901  
[www.msp-av.co.uk](http://www.msp-av.co.uk)

### **Adlib**

Adlib House (Reception Entrance)  
Kitling Road  
Knowsley Business Park  
Knowsley  
L34 9JS

Tel: 0151 486 2214  
[www.adlib.co.uk](http://www.adlib.co.uk)

### **Liverpool Scenic Workshops**

Mayflower Avenue  
Liverpool  
L24 9BA

Tel: 0151 486 5979  
[www.liverpoolscenicworkshops.co.uk](http://www.liverpoolscenicworkshops.co.uk)